

Demolition of the Roundhouse and Annex

State Project Number: H27-Z005

University of South Carolina

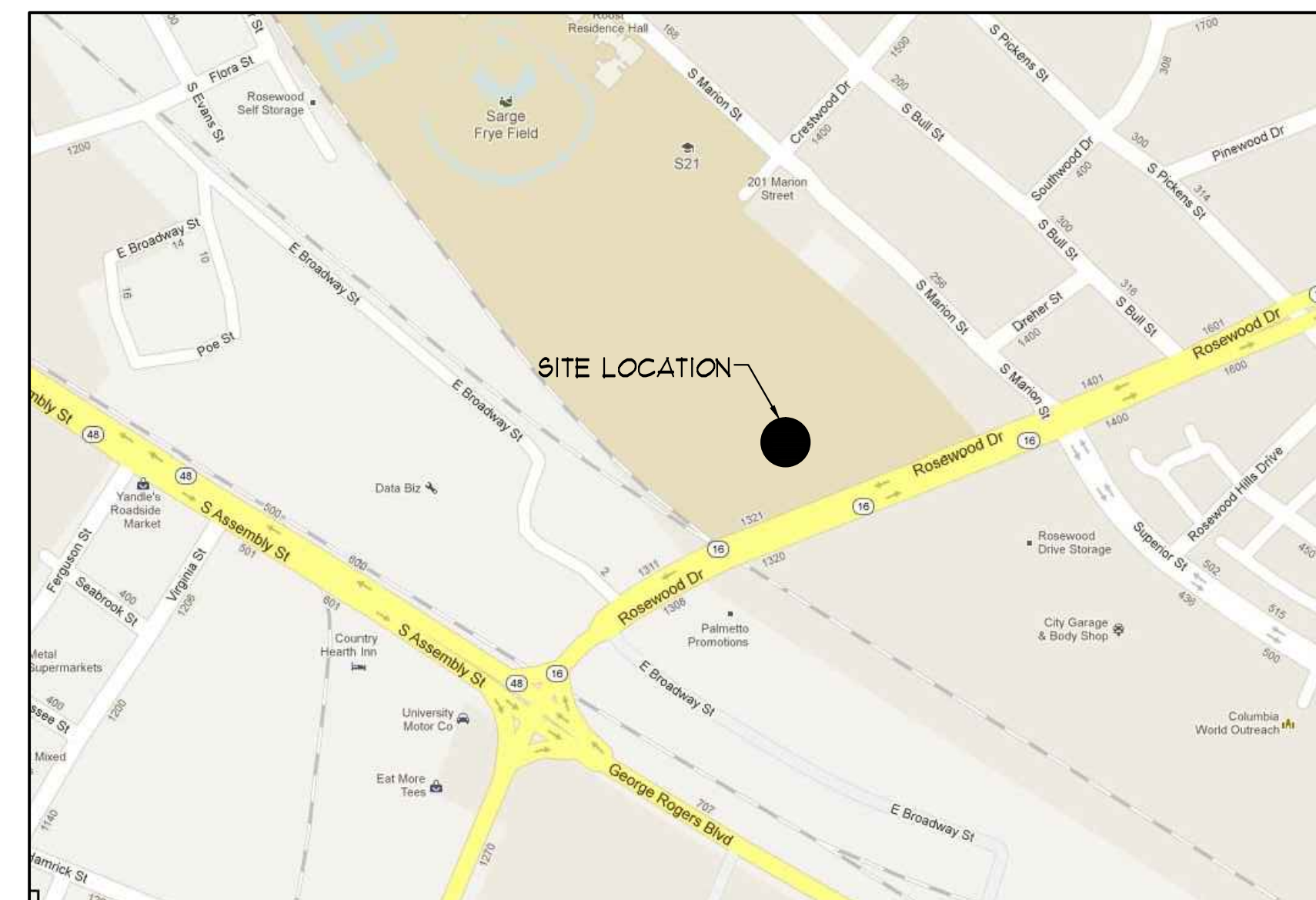

VICINITY PLAN
NOT TO SCALE

PROJECT CONTACTS

JOB SITE	_____
CONTRACTOR'S OFFICE	_____
OWNER	_____
Ann Dernick - Project Manager	803-777-5811
University of South Carolina	
ARCHITECT	_____
Todd Sease - Project Architect	803-791-1020
Jumper Carter Sease Architects, P.A.	

INDEX OF DRAWINGS

T101 TITLE, INDEX & ABBREVIATIONS
 D101 DEMOLITION SITE PLAN
 D102 FIRST FLOOR DEMOLITION PLAN
 D103 SECOND FLOOR DEMOLITION PLAN
 D104 DEMOLITION BUILDING SECTIONS
 D105 EXISTING PHOTOGRAPHS
 D106 EXISTING PHOTOGRAPHS

PROJECT GENERAL NOTES

1. THE CONTRACTOR IS TO VISIT THE SITE AND FAMILIARIZE HIMSELF WITH THE COMPLETE WORK SCOPE AND ALL RELATED CONDITIONS PRIOR TO BID. ANY QUESTIONS OR DISCREPANCIES WITH THE INFORMATION SHOWN HEREIN MUST BE DIRECTED TO THE ARCHITECT IN WRITING PRIOR TO BID. SUBMISSION OF BID WILL BE CONSIDERED AS EVIDENCE THAT THE CONTRACTOR HAS VISITED THE SITE OF WORK.
2. ALL TEMPORARY FACILITIES WILL BE THE RESPONSIBILITY OF THE CONTRACTOR.
3. THE CONTRACTOR IS REQUIRED TO MAINTAIN A CLEAN WORK SITE AT ALL TIMES. THE CONTRACTOR SHALL NOT ALLOW TRASH OR DEBRIS TO BECOME WIND BORNE SO AS TO LITTER ADJACENT AREAS OF THE SITE.

Jumper

Carter

Sease

Architects
PA
412 Meeting Street
West Columbia
South Carolina

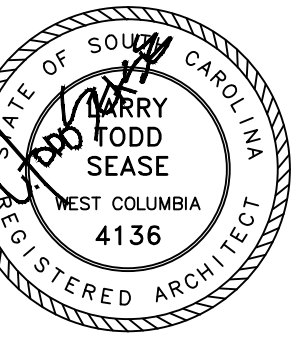

DEMOLITION OF THE ROUNDHOUSE AND ANNEX
UNIVERSITY OF SOUTH CAROLINA
COLUMBIA, SOUTH CAROLINA

REVISIONS:

DRAWN BY: BTC

CHECKED BY: LTS

COMM NO: 12101

DATE: SEPT. 24, 2012

SHEET TITLE:

TITLE SHEET

SHEET NO:

T101

These drawings are the property of Jumper Carter Sease Architects, PA and may not be reproduced, copied or used in whole or in part without written consent of the architect and any infringement will be subject to legal action.

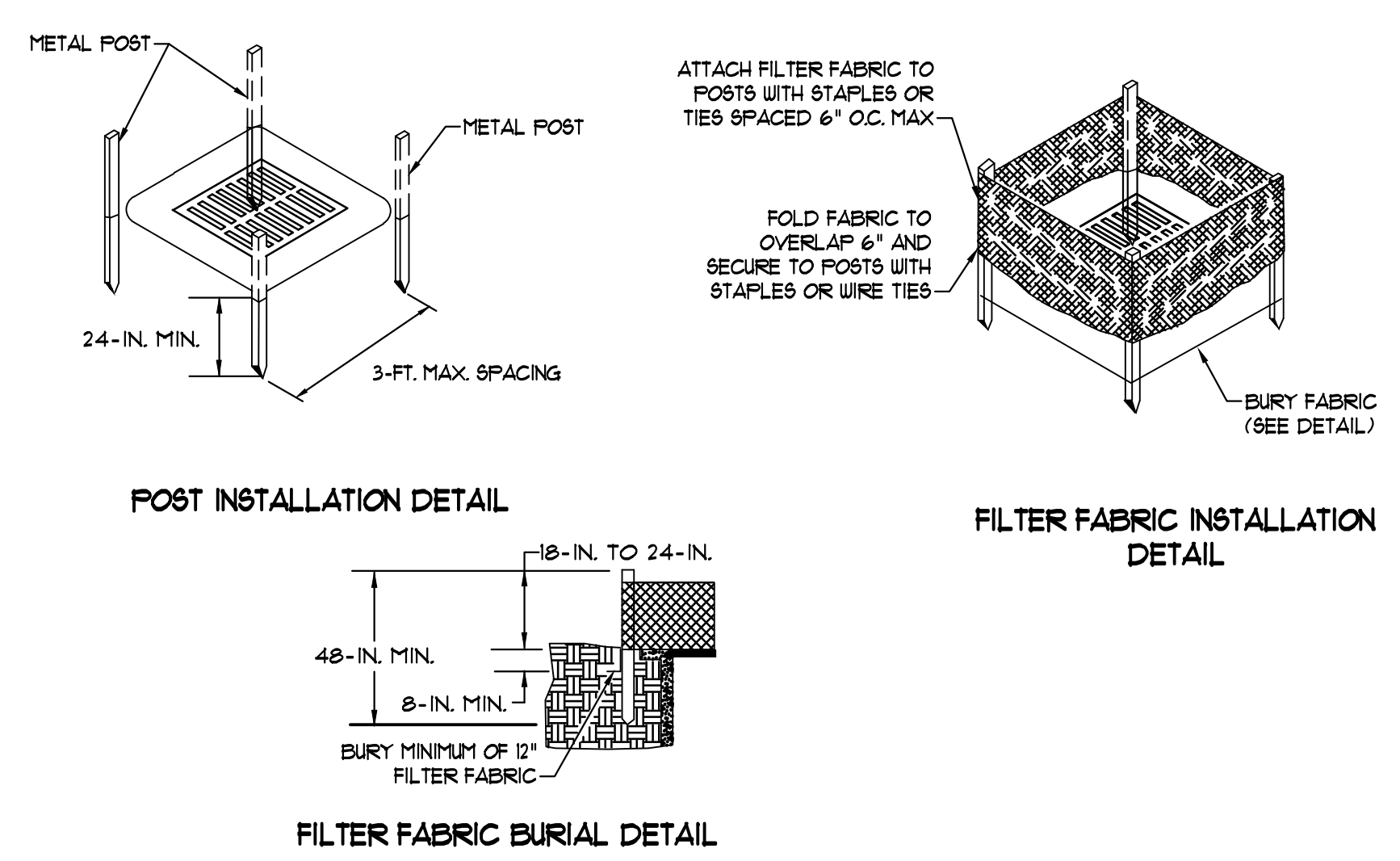

SILT-BOX INLET PROTECTION DETAIL
SCALE: NTS

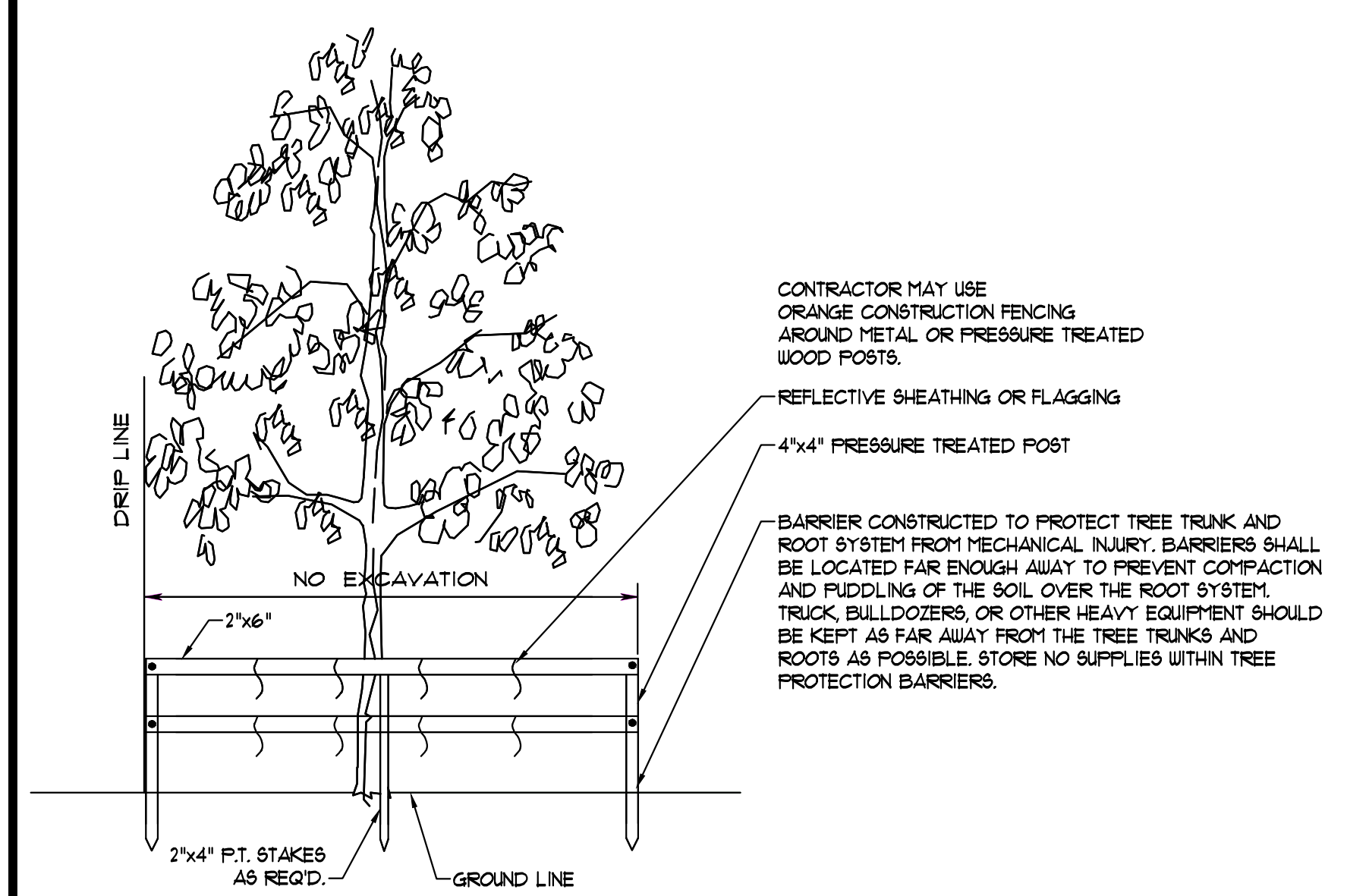

TREE PROTECTION DETAIL
SCALE: NTS

- NOTES:**
- ALL TREE PROTECTION BARRICADES MUST HAVE TWO HORIZONTAL CROSS RAILS.
 - TREE BARRICADES SHALL BE ERRECTED AT A MINIMUM DISTANCE FROM THE BASE OF THE PROTECTED TREES AND/OR GRAND TREES ACCORDING TO THE FOLLOWING STANDARDS:
A) FOR PROTECTED TREES (23" D.B.H. OR LESS), PROTECTIVE BARRICADES SHALL BE PLACED A MINIMUM DISTANCE OF TEN FEET FROM THE BASE OF EACH PROTECTED TREE.
B) FOR PROTECTED TREES GREATER THAN (23" D.B.H. AND GRAND TREES), PROTECTIVE BARRICADES SHALL PROVIDE A DIAMETER OF PROTECTION AROUND THE TREE EQUAL IN FEET TO THE DIAMETER, BREAST HEIGHT OF THE TREE (EX. A 24" DIAMETER TREE WOULD REQUIRE A 24 FOOT DIA. PROTECTIVE BARRICADE).

- DEMO NOTES:**
- EXISTING BUILDING SHALL BE REMOVED IN ITS ENTIRETY, INCLUDING ALL ROOFING, WALLS, FLOORING, DOORS, WINDOWS, CONCRETE SLAB, FOUNDATION WALLS, CONCRETE FOOTINGS, STRUCTURAL MEMBERS, ELECTRICAL EQUIPMENT, ELECTRICAL CONDUITS, PLUMBING EQUIPMENT, PLUMBING PIPING AND MECHANICAL EQUIPMENT, INCLUDING ADJACENT SIDEWALKS, ETC. WATER, SEWER AND GAS LINES SHALL BE CAPPED BELOW GRADE AT METER OR TAP. ALL MATERIAL SHALL BE REMOVED FROM THE SITE, TRANSPORTED LEGALLY TO A CERTIFIED LANDFILL SITE. ALL DISTURBED AREAS SHALL BE GRADED SMOOTH, CLEANED, RAKED THOROUGHLY TO REMOVE ALL DEBRIS AND HYDRO SEED WITH GRASS AS NOTED.
* PROTECT ADJACENT PARKING AREAS AND UTILITIES SCHEDULED TO REMAIN.
 - REMOVE EXISTING CONCRETE SIDEWALK.
 - EXISTING CONCRETE BRIDGE WALKWAY TO BE REMOVED IN ITS ENTIRETY INCLUDING COLUMNS, FOOTINGS & RAILING.
 - EXISTING MECHANICAL SYSTEMS & UNITS SHALL BE REMOVED IN ITS ENTIRETY INCLUDING ALL ASSOCIATED PIPING & WIRING.
 - EXISTING CYCLONE FENCING SHALL BE REMOVED INCLUDING ALL POST, BOTTOM AND TOP RAILS & CONCRETE POST FOOTINGS.
 - EXISTING WOOD RAMP/STAIR TO BE REMOVED IN ITS ENTIRETY.
 - EXISTING SHRUBBERY ADJACENT TO STRUCTURES SHALL BE REMOVED & GROUND FOR MULCH. PROTECT EXISTING TREES, TYP.
 - CERTAIN STORM DRAIN LINES & CATCH BASINS AS SHOWN ON DEMO PLAN SHALL BE REMOVED. PROTECT EXISTING CATCH BASINS SCHEDULED TO REMAIN. CAP PIPING CONNECTION AT CATCH BASINS SCHEDULED TO BE REMOVED.
 - REMOVE BUILDING LETTERS "REX ENRIGHT ATHLETIC CENTER" WITHOUT DAMAGE AND TURN OVER TO OWNER.

- GENERAL NOTES:**
- CATCH BASINS & STORM DRAIN PIPING SCHEDULED TO REMAIN. EXISTING STORM DRAIN LINES & CATCH BASINS INDICATED TO REMAIN IN PLACE SHALL BE PROTECTED DURING CONSTRUCTION. PROVIDE SILT FENCE & HAY BALES & CATCH BASINS SCHEDULED TO REMAIN. REMAINING TIE-IN BOX IS TO BE BRICKED UP AT REMOVAL POINT OF STORM DRAIN PIPING.

- GRASSING SPECIFICATIONS:**
- GRASS/SOIL PREPARATION:**
- REMOVE AND DISPOSE OF ALL ROCKS AND DEBRIS LARGER THAN 1/4" IN DIAMETER FROM THE AREAS.
 - USE A SEED-SILTER OVER THE ENTIRE AREA UNTIL A MIXTURE OF 180 LBS. OF COMMON BERMUDA SEED, 550 LBS. OF TURF TYPE FESCUE SEED, AND 500 LBS. OF 18-24-12 STARTER FERTILIZER IS INSERTED INTO THE SOIL.
 - AGGRESSIVELY CORE ABRATE (4" DEEP) WITH A PLUG CORER OVER THE ENTIRE AREA AND BACK DRAG SOIL INTO ANY LOW PLACES AS NEEDED.
 - OVER SEED ALL SHADY AREAS WITH ADDITIONAL TURF TYPE FESCUE AT THE RATE OF 3 LBS. PER 1000 SQFT. OR APPROXIMATELY 50 LBS. TOTAL.
- HYDROSEED:**
- HEAVILY HYDROSEED ALL AREAS USING A MIXTURE OF 180 LBS. OF COMMON BERMUDA SEED, 550 LBS. OF TURF TYPE FESCUE SEED, 500 LBS. OF 18-24-12 STARTER FERTILIZER, 750 LBS. OF LIME AND 1200-1400 LBS. OF WOOD MULCH FIBER.
 - WATER IN ALL AREAS ONE TIME.
- GRASS MATTING:**
- PROVIDE BIODEGRADABLE STRAW OR COCONUT FIBER MATTING OVER ALL SLOPED AREAS. INCLUDE MANUFACTURER'S RECOMMENDED STEEL WIRE STAPLES, 6 INCHES LONG.
- SEED PROTECTION:**
- USE CAUTION TAPE AND STAKES TO BARRICADE OFF ALL SEEDED AREAS UNTIL SEEDED AREAS ARE ESTABLISHED 10% COVERAGE.

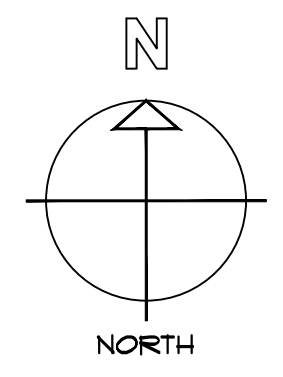
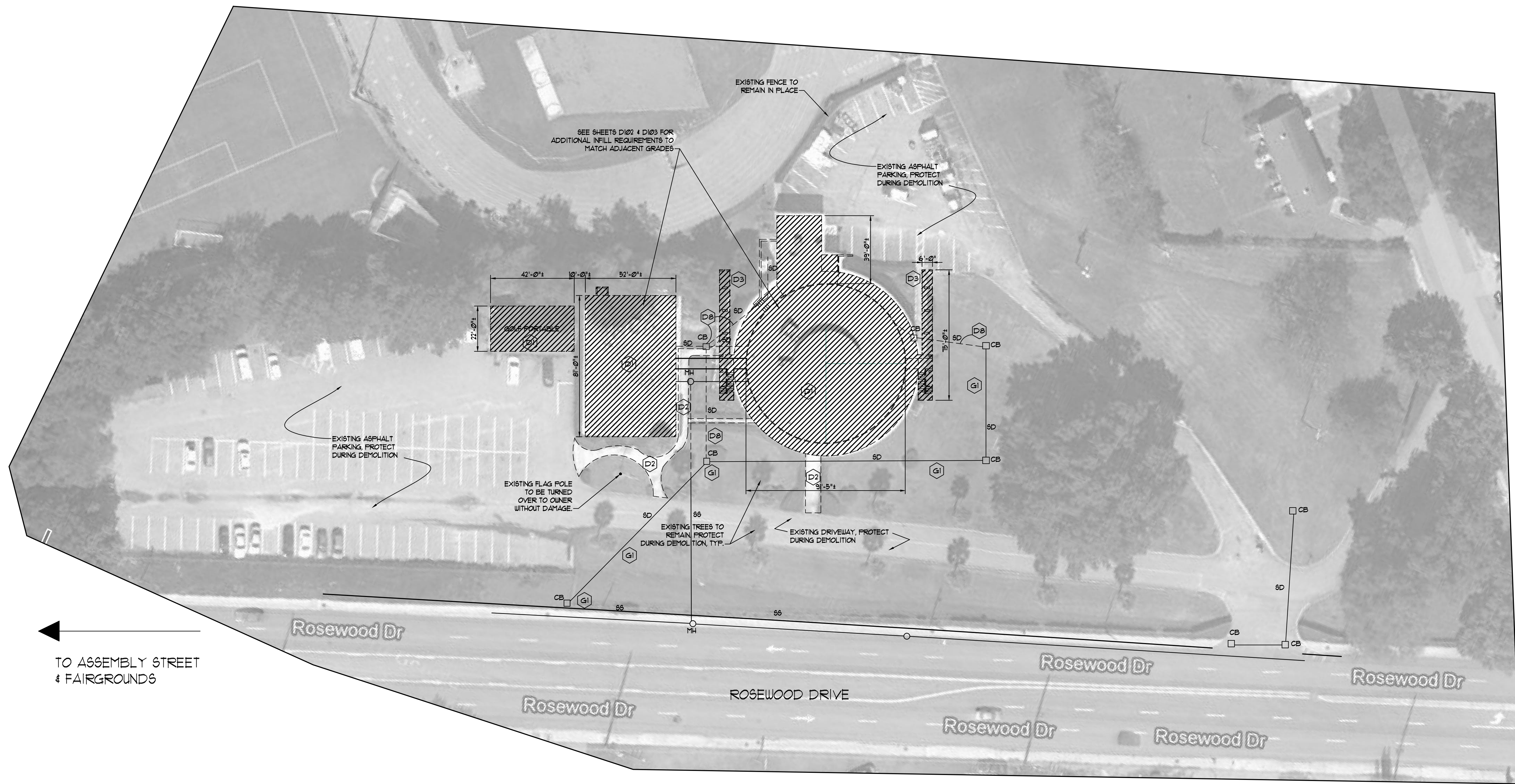

SITE DEMOLITION PLAN
SCALE: 1" = 30'

* DIMENSIONS ARE PLUS/MINUS FIELD VERIFY TYP.

Jumper
Carter
Sease

Architects
PA
412 Meeting Street
West Columbia
South Carolina

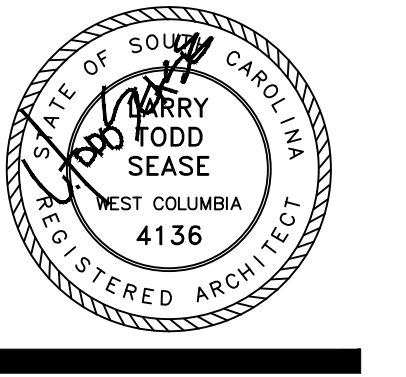
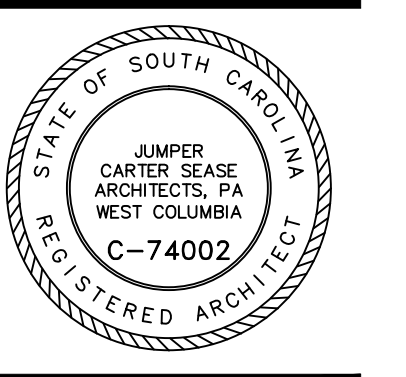

DEMOLITION OF THE ROUNDHOUSE AND ANNEX
UNIVERSITY OF SOUTH CAROLINA
COLUMBIA, SOUTH CAROLINA

REVISIONS:

DRAWN BY: BTC
CHECKED BY: LTS
COMM NO: 12101
DATE: SEPT. 24, 2012
SHEET TITLE:

SITE DEMOLITION PLAN

SHEET NO:
D101

these drawings are the property of Jumper Carter Sease Architects, PA and may not be reproduced, copied or used in whole or in part without written consent of the architect and any infringement will be subject to legal action.

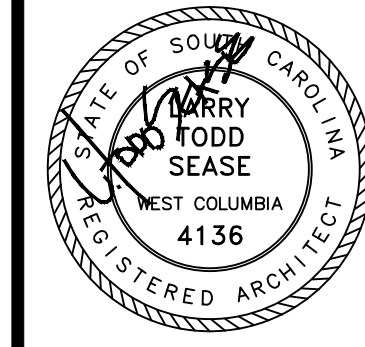
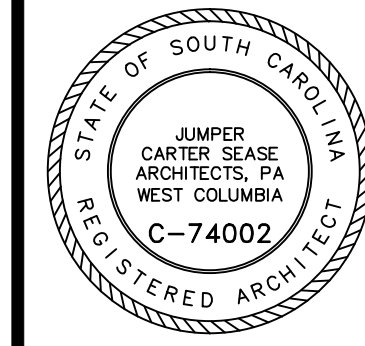

REVISIONS:

DRAWN BY: BTC
CHECKED BY: LTS
COMM NO.: 12101
DATE: SEPT. 24, 2012
SHEET TITLE:

FIRST FLOOR
DEMOLITION
PLAN

SHEET NO.:

D102

- DEMO NOTES:**
- D1 EXISTING BUILDING SHALL BE REMOVED IN ITS ENTIRETY, INCLUDING ALL ROOFING, WALLS, FLOORING, DOORS, WINDOWS, CONCRETE SLAB, FOUNDATION WALLS, CONCRETE FOOTINGS, STRUCTURAL MEMBERS, ELECTRICAL EQUIPMENT, ELECTRICAL CONDUITS, PLUMBING EQUIPMENT, PLUMBING PIPING AND MECHANICAL EQUIPMENT, INCLUDING ADJACENT SIDEWALKS, ETC. WATER, SEWER AND GAS LINES SHALL BE CAPPED BELOW GRADE AT METER OR TAP. ALL MATERIAL SHALL BE REMOVED FROM THE SITE, TRANSPORTED LEGALLY TO A CERTIFIED LANDFILL SITE. ALL DISTURBED AREAS SHALL BE GRADED SMOOTH, CLEANED, RAKED THOROUGHLY TO REMOVE ALL DEBRIS AND HYDRO SEED WITH GRASS AS NOTED.
 - * PROTECT ADJACENT PARKING AREAS AND UTILITIES SCHEDULED TO REMAIN.
 - D2 REMOVE EXISTING CONCRETE SIDEWALK.
 - D3 EXISTING CONCRETE BRIDGE WALKWAY TO BE REMOVED IN ITS ENTIRETY INCLUDING COLUMNS, FOOTINGS & RAILING.
 - D4 EXISTING MECHANICAL SYSTEMS & UNITS SHALL BE REMOVED IN ITS ENTIRETY INCLUDING ALL ASSOCIATED PIPING & WIRING.
 - D5 EXISTING CYCLONE FENCING SHALL BE REMOVED INCLUDING ALL POST, BOTTOM AND TOP RAILS & CONCRETE POST FOOTINGS.
 - D6 EXISTING WOOD RAMP/STAIR TO BE REMOVED IN ITS ENTIRETY.
 - D7 EXISTING SHRUBBERY ADJACENT TO STRUCTURES SHALL BE REMOVED & GROUND FOR MULCH. PROTECT EXISTING TREES, TYP.
 - D8 CERTAIN STORM DRAIN LINES & CATCH BASINS AS SHOWN ON DEMO PLAN SHALL BE REMOVED. PROTECT EXISTING CATCH BASINS SCHEDULED TO REMAIN. CAP PIPING CONNECTION AT CATCH BASINS SCHEDULED TO BE REMOVED.
 - D9 REMOVE BUILDING LETTERS "REX ENRIGHT ATHLETIC CENTER" WITHOUT DAMAGE AND TURN OVER TO OWNER.

PROVIDE ADDITIONAL SOIL INFILL AS REQUIRED AFTER DEMOLITION SO THAT EXISTING SLAB, FOOTING, AND WALK REMOVAL GRADES ARE INFILLED & ROLLED (8" LIFTS) FLUSH WITH EXISTING ADJACENT GRADES PRIOR TO SEEDING.
ALSO PROVIDE ADDITIONAL SOIL INFILL AS REQUIRED AFTER THE REMOVAL OF THE REAR RETAINING WALL AND PRIOR TO SEEDING IN ORDER TO MAINTAIN EXISTING ADJACENT SLOPES IN GRADE AND BE CONSISTENT IN GRADE UPON COMPLETION. MAXIMUM SLOPE TO BE 3:1. TOP SOIL IS TO BE HIGH QUALITY & SCREENED. FINAL GRADING MUST BE WITH POSITIVE SLOPES & NOT ALLOW FOR PONDING WATER.

PROVIDE ADDITIONAL SOIL INFILL AS REQUIRED AFTER DEMOLITION SO THAT EXISTING SLAB, FOOTING, AND WALK REMOVAL GRADES ARE INFILLED & ROLLED (8" LIFTS) FLUSH WITH EXISTING ADJACENT GRADES PRIOR TO SEEDING. TOP SOIL IS TO BE HIGH QUALITY & SCREENED. FINAL GRADING MUST BE WITH POSITIVE SLOPES & NOT ALLOW FOR PONDING WATER.

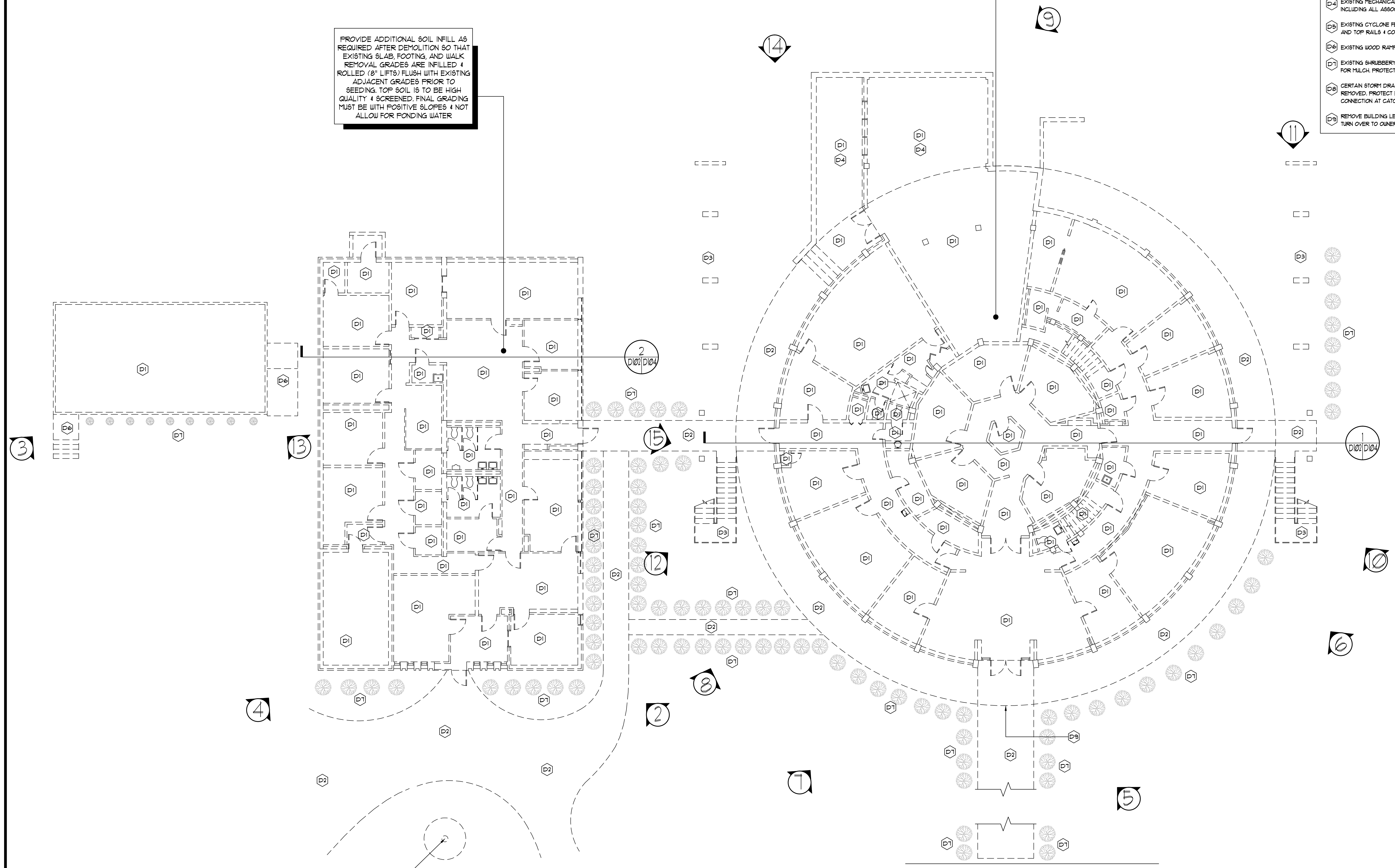

EXISTING POLE TO BE REMOVED & TURNED OVER TO THE OWNER WITHOUT DAMAGE

EXISTING DRIVEWAY. PROTECT DURING DEMOLITION

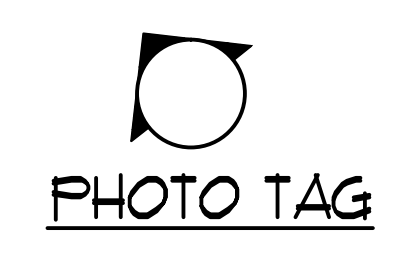

FIRST FLOOR DEMOLITION PLAN
SCALE: 1/8" = 1'-0"

These drawings are the property of Jumper Carter Sease Architects, PA and may not be reproduced, copied or used in whole or in part without written consent of the architect and any infringement will be subject to legal action.

PROVIDE ADDITIONAL SOIL INFILL AS REQUIRED AFTER DEMOLITION SO THAT EXISTING SLAB, FOOTING, AND WALK REMOVAL GRADES ARE INFILLED & ROLLED (8" LIFTS) FLUSH WITH EXISTING ADJACENT GRADES PRIOR TO SEEDING.

ALSO PROVIDE ADDITIONAL SOIL INFILL AS REQUIRED AFTER THE REMOVAL OF THE REAR RETAINING WALL, PRIOR TO SEEDING, IN ORDER TO MAINTAIN EXISTING ADJACENT SLOPES IN GRADE AND BE CONSISTENT IN GRADE UPON COMPLETION. MAXIMUM SLOPE TO BE 3:1. TOP SOIL IS TO BE HIGH QUALITY & SCREENED. FINAL GRADING MUST BE WITH POSITIVE SLOPES & NOT ALLOW FOR PONDING WATER.

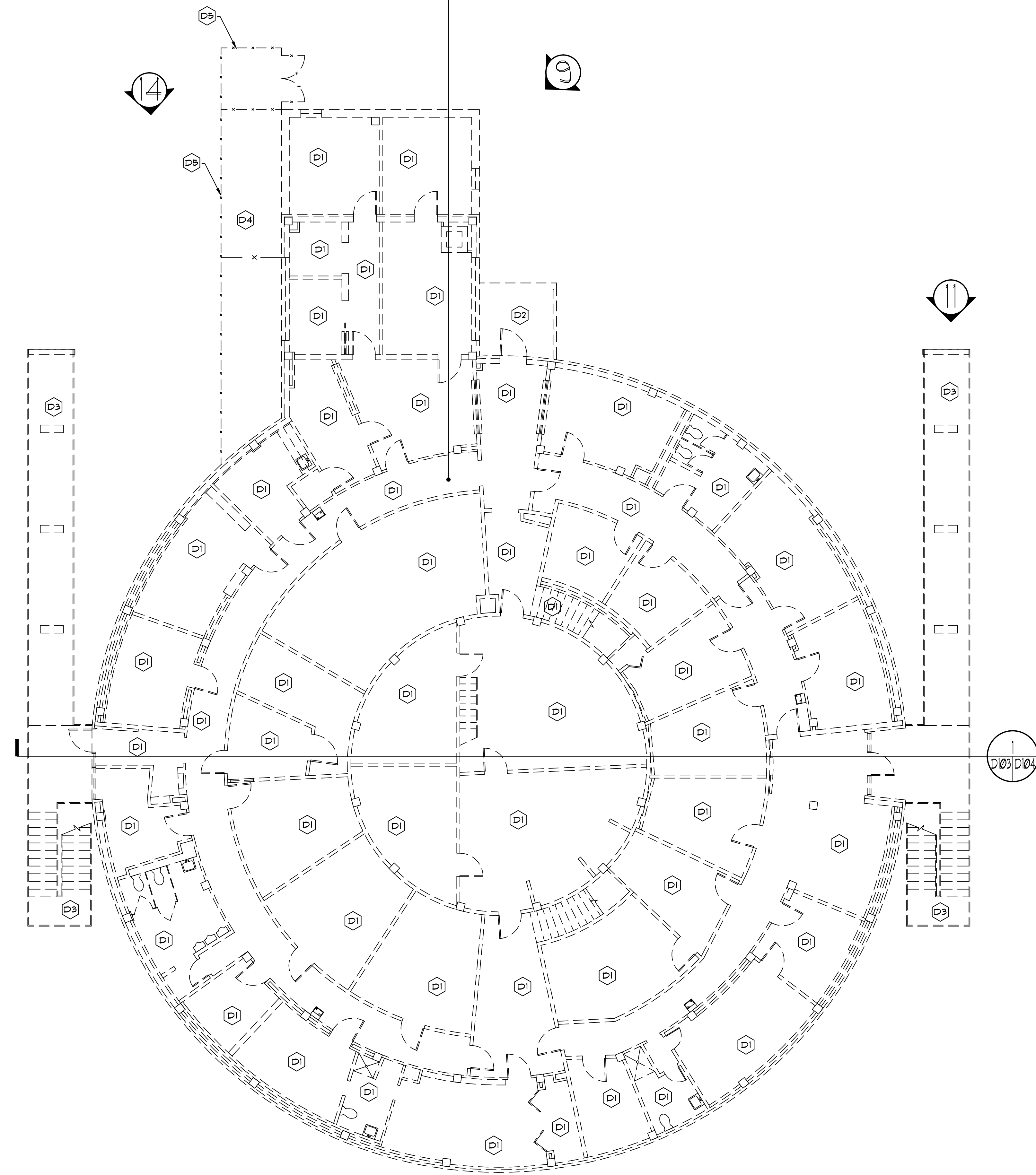

SECOND FLOOR DEMOLITION PLAN
SCALE: 1/8" = 1'-0"

- DEMO NOTES:**
- D1 EXISTING BUILDING SHALL BE REMOVED IN ITS ENTIRETY, INCLUDING ALL ROOFING, WALLS, FLOORING, DOORS, WINDOWS, CONCRETE SLAB, FOUNDATION WALLS, CONCRETE FOOTINGS, STRUCTURAL MEMBERS, ELECTRICAL EQUIPMENT, ELECTRICAL CONDUITS, PLUMBING EQUIPMENT, PLUMBING PIPING AND MECHANICAL EQUIPMENT, INCLUDING ADJACENT SIDEWALKS, ETC. WATER, SEWER AND GAS LINES SHALL BE REMOVED FROM THE SITE, TRANSPORTED LEGALLY TO A CERTIFIED LANDFILL SITE. ALL DISTURBED AREAS SHALL BE GRADED SMOOTH, CLEANED, RAKED THOROUGHLY TO REMOVE ALL DEBRIS AND HYDRO SEED WITH GRASS AS NOTED.
 - * PROTECT ADJACENT PARKING AREAS AND UTILITIES SCHEDULED TO REMAIN.
 - D2 REMOVE EXISTING CONCRETE SIDEWALK.
 - D3 EXISTING CONCRETE BRIDGE WALKWAY TO BE REMOVED IN ITS ENTIRETY INCLUDING COLUMNS, FOOTINGS & RAILING.
 - D4 EXISTING MECHANICAL SYSTEMS & UNITS SHALL BE REMOVED IN ITS ENTIRETY INCLUDING ALL ASSOCIATED PIPING & WIRING.
 - D5 EXISTING CYCLONE FENCING SHALL BE REMOVED INCLUDING ALL POST, BOTTOM AND TOP RAILS & CONCRETE POST FOOTINGS.
 - D6 EXISTING WOOD RAMP/STAIR TO BE REMOVED IN ITS ENTIRETY.
 - D7 EXISTING SHRUBBERY ADJACENT TO STRUCTURES SHALL BE REMOVED & GROUND FOR MULCH. PROTECT EXISTING TREES, TYP.
 - D8 CERTAIN STORM DRAIN LINES & CATCH BASINS AS SHOWN ON DEMO PLAN SHALL BE REMOVED. PROTECT EXISTING CATCH BASINS SCHEDULED TO REMAIN. CAP PIPING CONNECTION AT CATCH BASINS SCHEDULED TO BE REMOVED.
 - D9 REMOVE BUILDING LETTERS "REX ENRIGHT ATHLETIC CENTER" WITHOUT DAMAGE AND TURN OVER TO OWNER.

**Jumper
Carter
Sease**
Architects
PA
412 Meeting Street
West Columbia
South Carolina

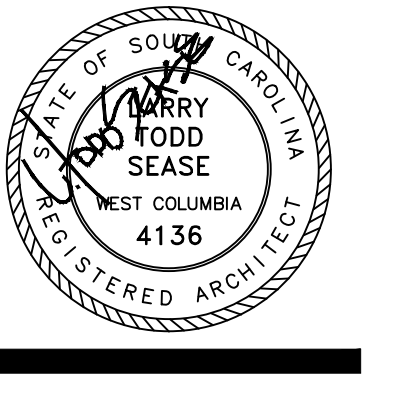
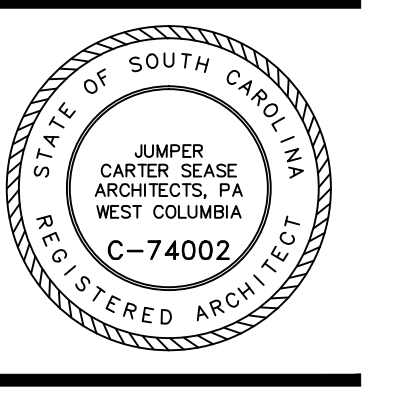

**DEMOLITION OF THE ROUNDHOUSE AND ANNEX
UNIVERSITY OF SOUTH CAROLINA
COLUMBIA, SOUTH CAROLINA**

REVISIONS:

DRAWN BY: BTC
CHECKED BY: LTS
COMM NO: 12101
DATE: SEPT. 24, 2012
SHEET TITLE:

FIRST FLOOR
DEMOLITION
PLAN

SHEET NO:
D103

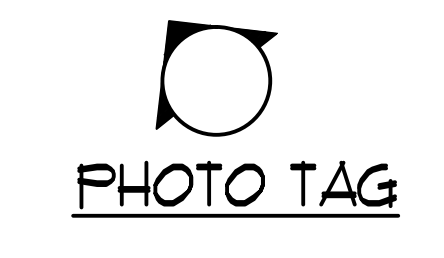

these drawings are the property of Jumper Carter Sease Architects, PA and may not be reproduced, copied or used in whole or in part without written consent of the architect and any infringement will be subject to legal action.

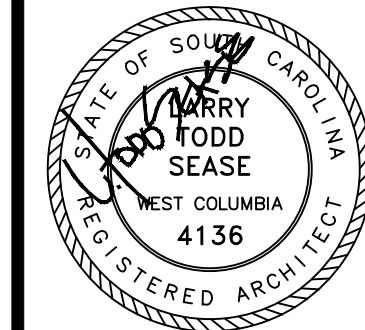
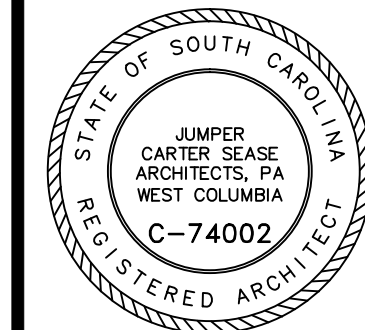

these drawings are the property of Jumper Carter Sease Architects, PA and may not be reproduced, copied or used in whole or in part without written consent of the architect and any infringement will be subject to legal action.

DEMOLITION OF THE ROUNDHOUSE AND ANNEX
UNIVERSITY OF SOUTH CAROLINA
COLUMBIA, SOUTH CAROLINA

REVISIONS:

DRAWN BY: BTC

CHECKED BY: LTS

COMM NO: 12101

DATE: SEPT. 24, 2012

SHEET TITLE:

BUILDING SECTIONS

SHEET NO:

D104

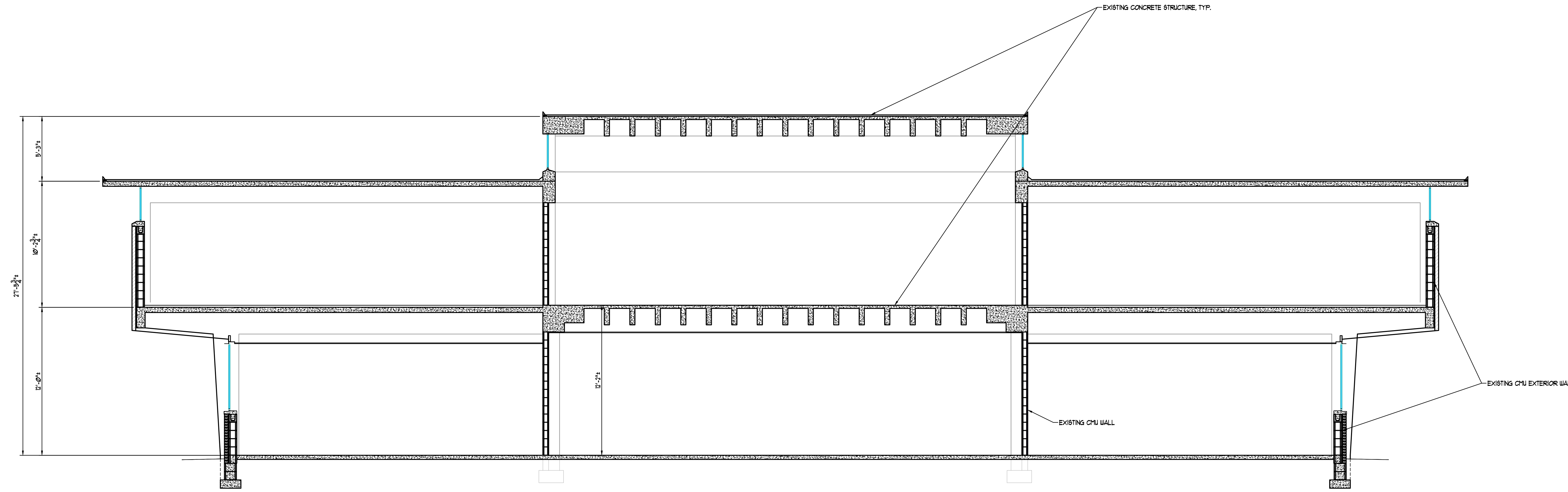

1 BUILDING SECTION TO BE DEMOLISHED
SCALE: 1/4" = 1'-0"

* PROVIDED FOR INFORMATION ONLY
FIELD VERIFY PRIOR TO BIDDING

*NOTE: INTERIOR WALLS NOT SHOWN
FOR CLARITY, TYP.

* DIMENSIONS ARE PLUS/MINUS FIELD
VERIFY TYP.

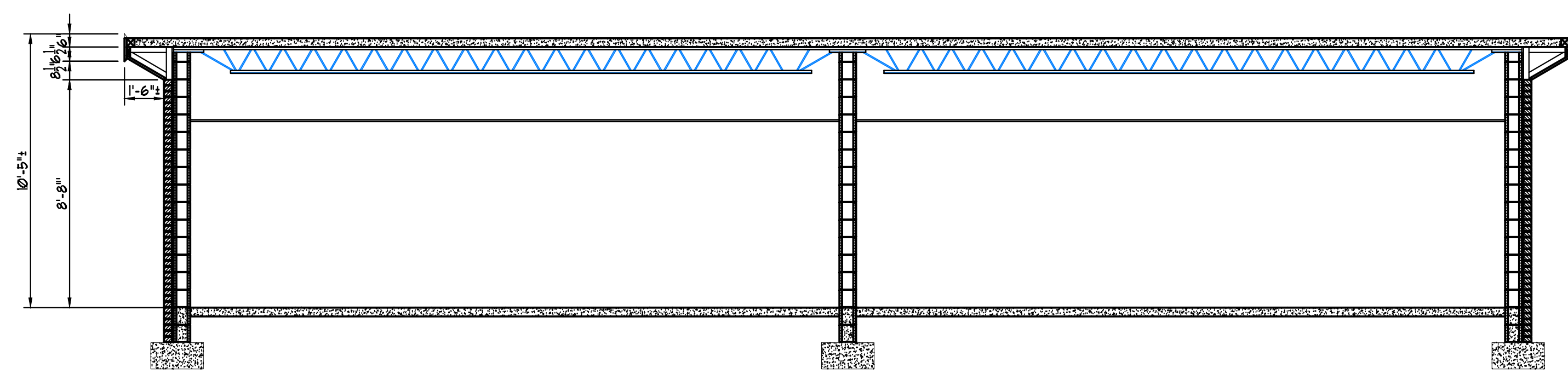

2 BUILDING SECTION TO BE DEMOLISHED
SCALE: 1/4" = 1'-0"

* PROVIDED FOR INFORMATION ONLY
FIELD VERIFY PRIOR TO BIDDING

*NOTE: INTERIOR WALLS NOT SHOWN
FOR CLARITY, TYP.

* DIMENSIONS ARE PLUS/MINUS FIELD
VERIFY TYP.



PHOTO



PHOTO



PHOTO



PHOTO



PHOTO



PHOTO



PHOTO



PHOTO



PHOTO

Jumper

Carter

Sease

Architects
PA
412 Meeting Street
West Columbia
South Carolina

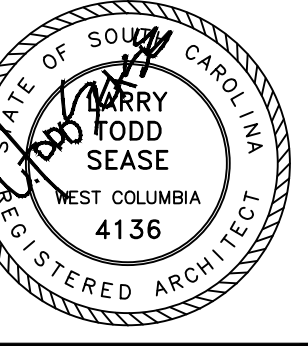

DEMOLITION OF THE ROUNDHOUSE AND ANNEX
UNIVERSITY OF SOUTH CAROLINA
COLUMBIA, SOUTH CAROLINA

These drawings are the property of Jumper Carter Sease Architects, PA and may not be reproduced, copied or used in whole or in part without written consent of the architect and any infringement will be subject to legal action.

REVISIONS:

DRAWN BY: BTC

CHECKED BY: LTS

COMM NO: 12101

DATE: SEPT. 24, 2012

SHEET TITLE:

EXISTING PHOTOGRAPHS

SHEET NO:

D105



10 PHOTO



11 PHOTO



12 PHOTO



13 PHOTO



14 PHOTO



15 PHOTO

Jumper

Carter

Sease

Architects
PA
412 Meeting Street
West Columbia
South Carolina

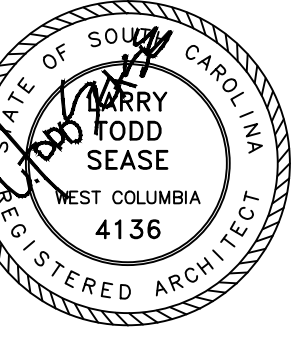

DEMOLITION OF THE ROUNDHOUSE AND ANNEX
UNIVERSITY OF SOUTH CAROLINA
COLUMBIA, SOUTH CAROLINA

these drawings are the property of Jumper Carter Sease Architects, PA and may not be reproduced, copied or used in whole or in part without written consent of the architect and any infringement will be subject to legal action.

REVISIONS:

DRAWN BY: BTC

CHECKED BY: LTS

COMM NO: 12101

DATE: SEPT. 24, 2012

SHEET TITLE:

EXISTING PHOTOGRAPHS

SHEET NO:

D106